

data sheet

Colenta[®]

Colenta New Generation
Film Processor

Film Processor

20 BW 30 5Tank Eco



Colenta[®]

Colenta FILM Processor - Type Black&White Eco
for roll and sheet format



11/2019 AN

Colenta[®] Film Processor

20 BW 30 5Tank Eco

Technical Specifications:

Processing applications:	Black&White film in roll and sheet format	
Process width:	20cm	
Microprocessor Control:	# 6 pre-programmable processing cycles # 1 over night (sleep program) incl "wake-up" feature	
Processing capacity	31cm/min @ 90 Sec Developer Time 28cm/min @ 100 Sec Developer Time 24cm/min @ 110 Sec Developer Time (Dev time is pre-programmable)	

Tank capacities: 20 BW 30 5Tank Eco

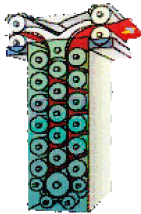

Developer	:	6,0 litre
Fixer	:	11,0 litre
Wash1	:	8,5 litre
Wash2	:	8,5 litre
Wetting	:	6,0 litre

All Colenta Film processor options are micro processor controlled and provide a fully automatic Dry to Dry service for both cut sheet and long roll through a well proven minimum contact hard roller transport system.

Replenishment:	- precisely controlled using opto-sensors to measure the area loading. - activated after a pre-set film area is fed into the processor
High efficiency drying:	via integrated warm air drying system supporting airknives
Temperatures:	All solution temperatures are accurately controlled and monitored with automatic cold water cooling - chiller systems are optional vavailable.
Transport/ Drive motor:	precisely controlled by electronic feed-back to ensure consistant developer timing

Standard Accessories:-

- # Level control for all Processing & Wash tanks # Rack Carrier/Drip Tray
- # 30 litre Replenishment storage tanks # water supply / drain connectors # CE marking
- # user spare part kit

Optional Accessories:

- # Inbuild Roll feed unit to include into the light tight feed box and long roll feed cradle with spool bobbins
- # Motorised Roll Take-Up # extra spool bobbins # UPS battery back up # chiller unit
- # water supply panel # 2 position chemical mixing concole (2x40L / 2x80L)

Technical specification subject to change without notice.

Colanta 20 BW 30 5Tank Eco

Transport system:

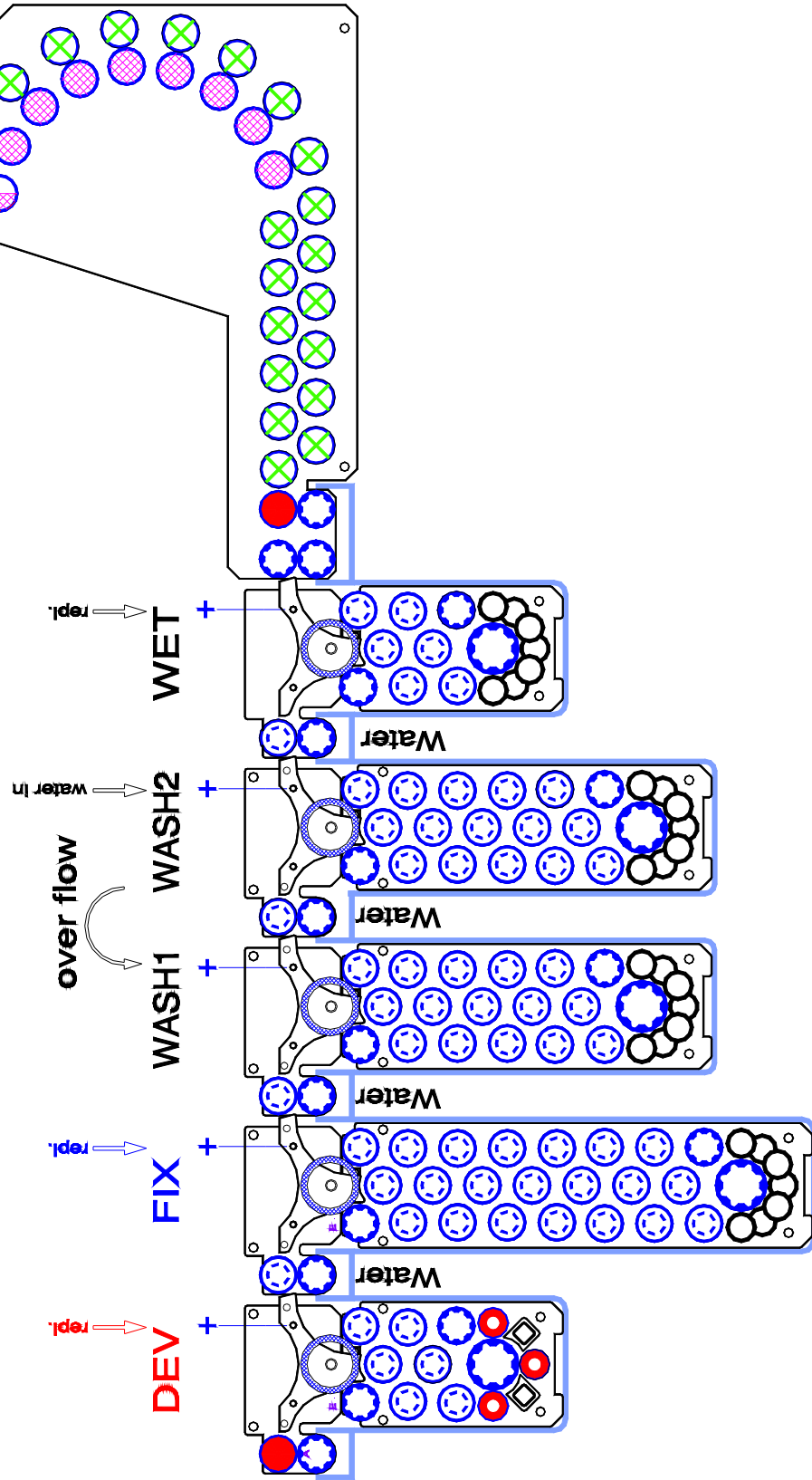

All transport modules (racks) and tanks are designed to reduce chemical oxidation to an absolute minimum. This together with our accurate replenishment, temperature control and constant circulation ensures all processing parameters are maintained within pre-set programmable limits.

Tank timings & ratios:

Colenta® 20 BW 30 5Tank Eco

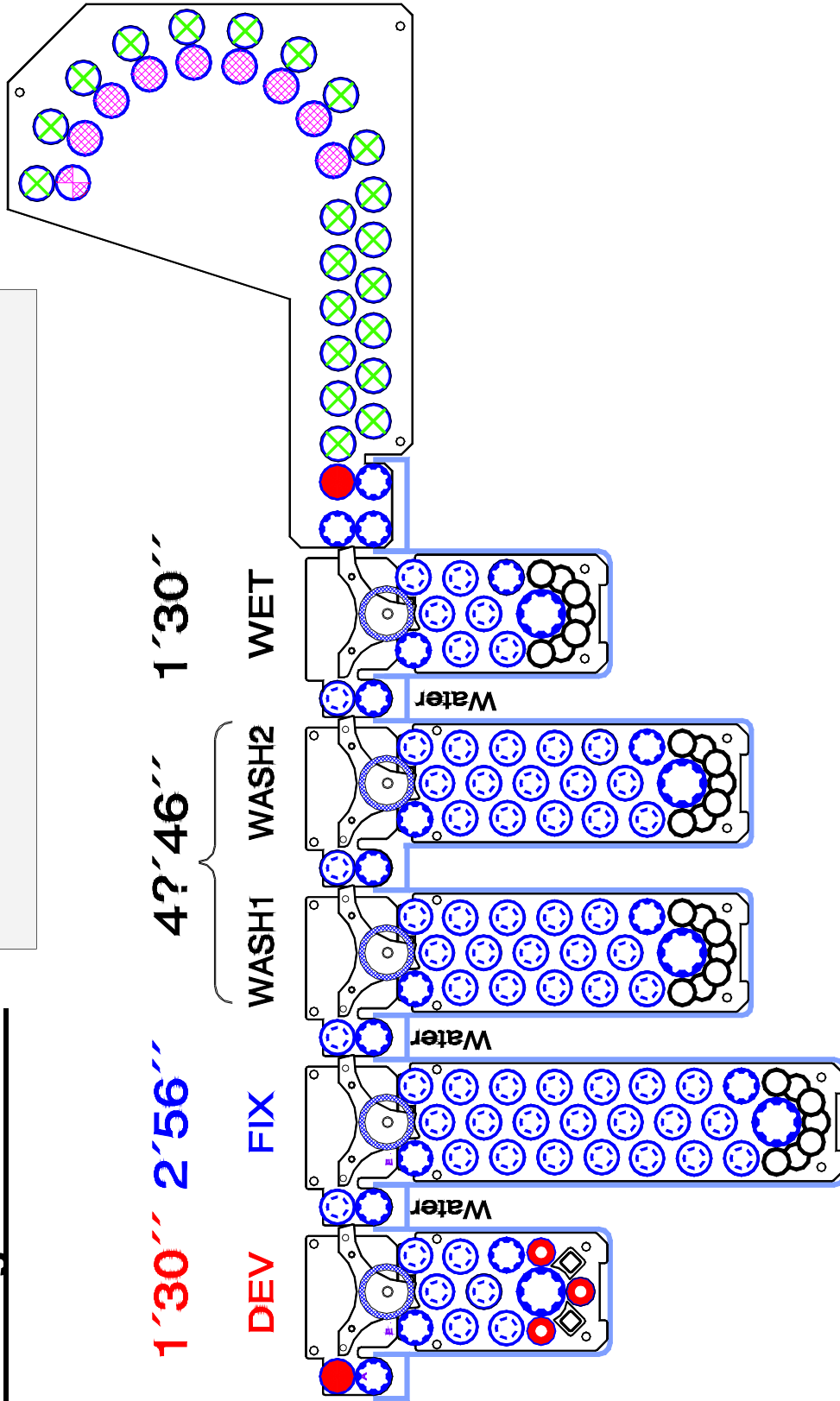

Water rinsed cross over rollers are in place in order to minimize the chemical carry over from one tank to the next as well to keep the cross over section clean and free from any chemical deposits.

Dimensions:

Colenta[®] 20 BW 30 5Tank Eco

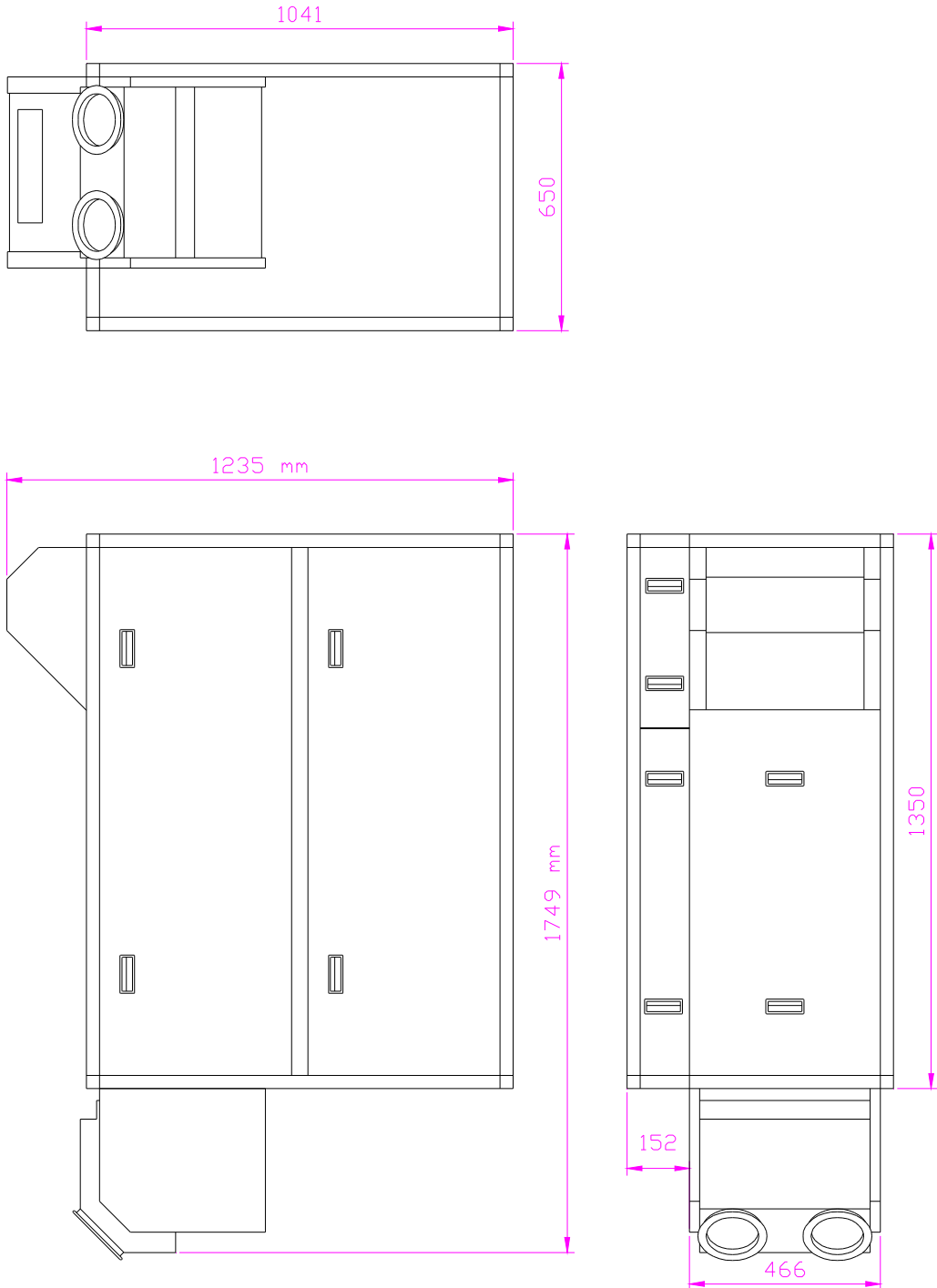

We recommend a minimum walking space of 60cm around the processor.

Specifications for wall-opening if the processor has to be installed that way:

Colenta[®] 20 BW 30 5Tank Eco

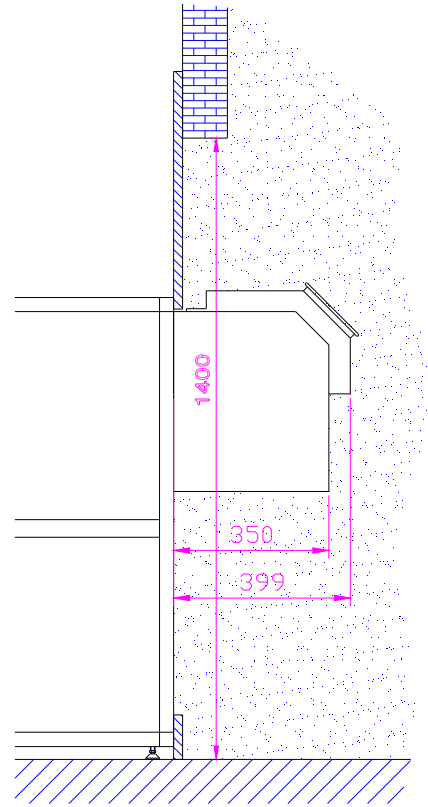
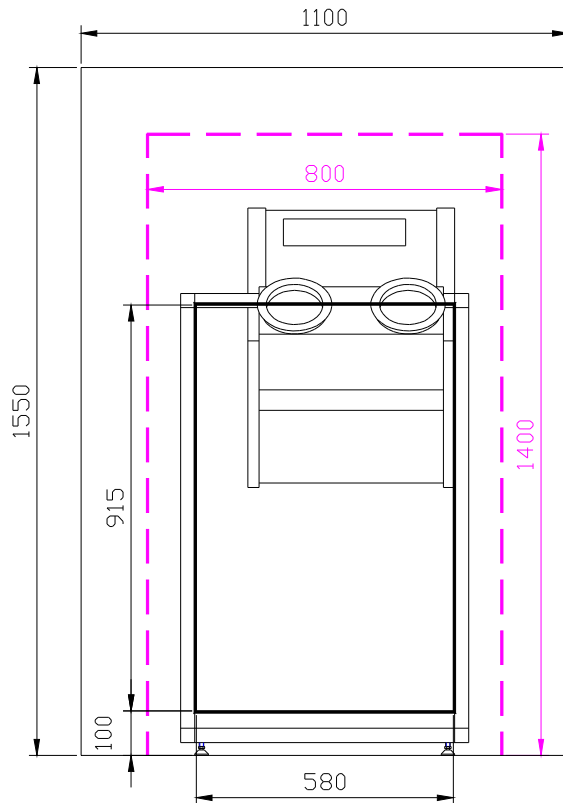

dim. of required wall opening approx. 1400x800mm

dim. of required wall panel approx. 1550x1100x20mm

dim. of clearance wall panel approx. 915x580mm

In case the thickness of the wall is more than 2cm, a wall panel panel has to be installed, this to be able to operate the cover lid of the film loading box.

Electrical supply:

Standard, when 3N~400/230V,
50/60 Hz supply available



Total power consumption:

20 BW 30 5Tank Eco..... 14.5 kW
@ 230VAC 50/60Hz single phase connection

Details for shipment:



20 BW 30 5Tank Eco

190 x 85 x 151cm 320 kg

All dimensions & weights are subject to final confirmation.

Colenta 20 BW 30 5Tank Eco

Colenta® 20 BW 30 5Tank Eco accessories included:

rack drip tray



loading guide for 35mm / 120 film



10 pcs film leaders & punch tool



anti oxidation cover for wet section



small user parts kit

basic plumbing connectors for water supply and drain



30 litre capacity replenisher tanks incl cover for each chemical tank

Colenta® 20 BW 30 5Tank Eco optional accessories:



Colenta®
Water Supply Panel assy
(see extra documentation)

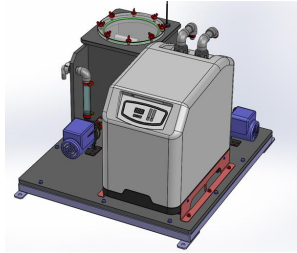

Colenta®
external chiller unit



day-light
loading option

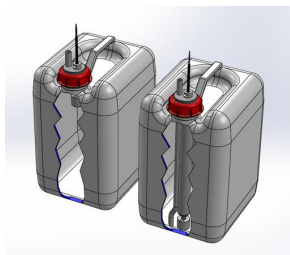

external 10 or 20 litre
chemical waste
container incl high
level monitoring



low level control for external
replenisher tanks



sleep mode / over night
program incl "auto wake-up" function

Colenta®
2x40L / 2x80L Mixing Concole
(see extra documentation)



roll feed & motorized
take up

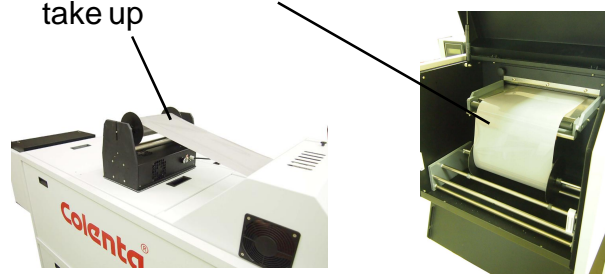

UPS Battery power supply back
up system



PVC processor floor trough

